

3 Liscombe East - Warehouse



LISCOMBE PARK

Liscombe Park

This beautiful Park provides tenants with an impressive location for their business, as well as the advantages of easy and fast access by road. Milton Keynes, Aylesbury and Leighton Buzzard are between 15 and 30 minutes away and there is easy access to the M1 and M40.

There are riding stables on site for those of an equestrian bent and a fully functioning Health Club comprising a cafe/bar with lunch menu, Gym, exercise studio (with regular classes), a large swimming pool, massage and chiropractic services. Introductory membership to the Health Club can be negotiated for new tenants.



Warehouse Dimensions

Up to 3500 sq ft

Including office of 180 sq ft

Roller shutter door	-Height	13 ft
	-width	14 ft
Eaves	-Height	16 ft

High Speed Broadband available.

Flexible Lease terms.

Allocated Parking

Yard



3 Liscombe East - Warehouse

Warehouse Layout (Red Line within building)

Yard area (to be agreed)

Allocated car parking to north side of shutter doors

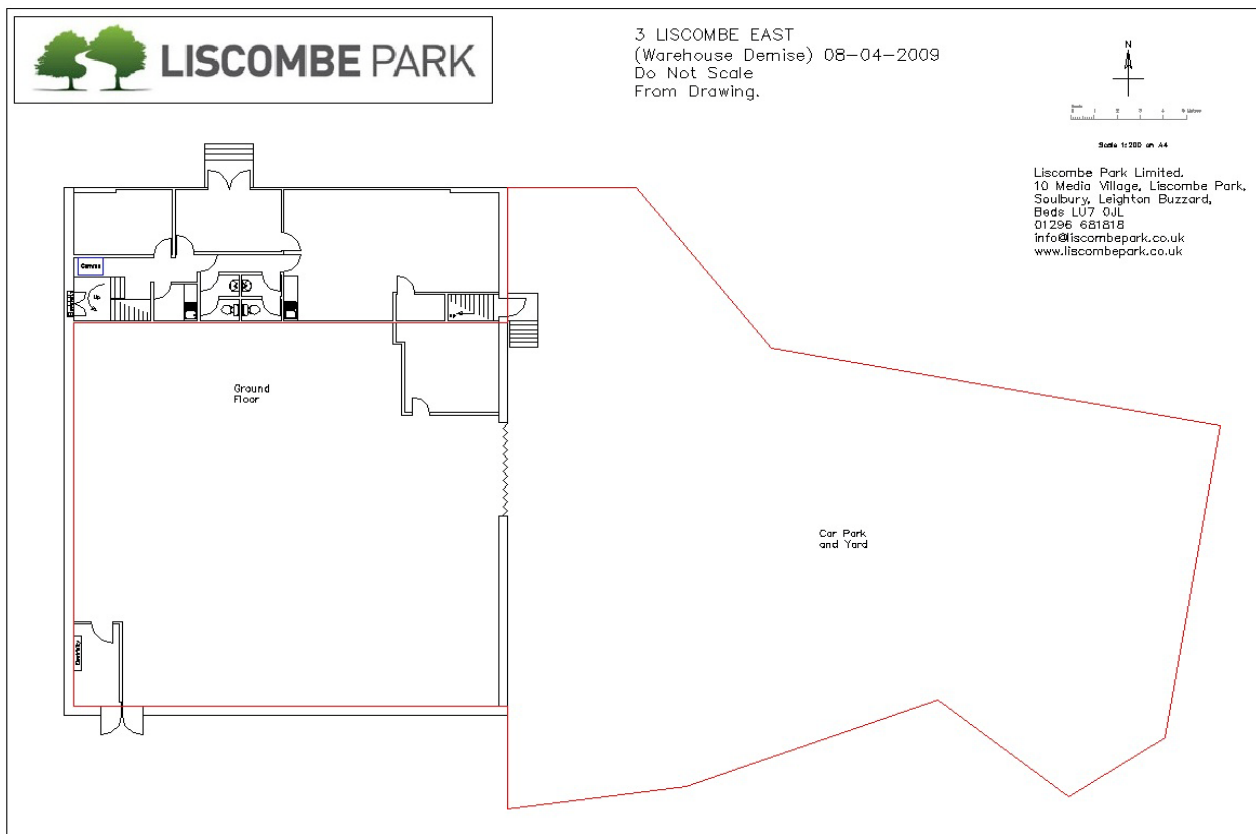

Lease Terms

Minimum 6 Months, but longer terms available.

Rent £1020.00 pm

Service charge £55 pm

Contact: David Tonnison

Work: 01296 681818

Mobile: 07811 45 99 96

Email: info@liscombepark.co.uk.

www.liscombepark.co.uk